

Safe & Secure

Safety and security rules

Prohibited



OPS area + Container Handling Equipment

Compulsory

Personal Protective Equipment



At the Terminal



Register



Use designated parking area



Turn on four turn signals or flashing light



Emergency number +32 (0)50 50 25 25

REGISTRATION WITH SECURITY

- I use my **alfapass** at every **passage** and **never badge** for others.



- I always **register** any **passengers** with **security**.
- **Persons** under the age of **18** need **permission** to **access** the **grounds**.
- You must **identify** yourself at the request of **security** staff.

GENERAL

- I am **never** in possession/under the influence of **alcohol/drugs**.
- **Smoking** is permitted only in the **designated** smoking areas.
- **No filming** or **photography** allowed at the terminal.



EMERGENCY

If the evacuation alarm is sounded, proceed to the assembly point.

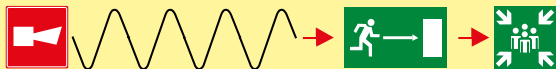

Report all incidents/unsafe situations by dialling **+32 (0)50 50 25 25**

AT THE TERMINAL

- At the terminal, always make sure you wear the compulsory personal protective equipment.



- Always use the four direction indicators or flashing light on your vehicle on the service lane.



or



- Observe the speed limit as specified.



or



- Give way to vehicles handling containers and pedestrians at all times.

- Making/taking mobile telephone calls at the terminal = pull over/stop working.



- Park your vehicle in the designated parking area only.



- Observe the markings/signage.



- The operations area, the installations and the equipment are off limits to unauthorised persons.



- Never position yourself underneath a load and maintain a safe distance.



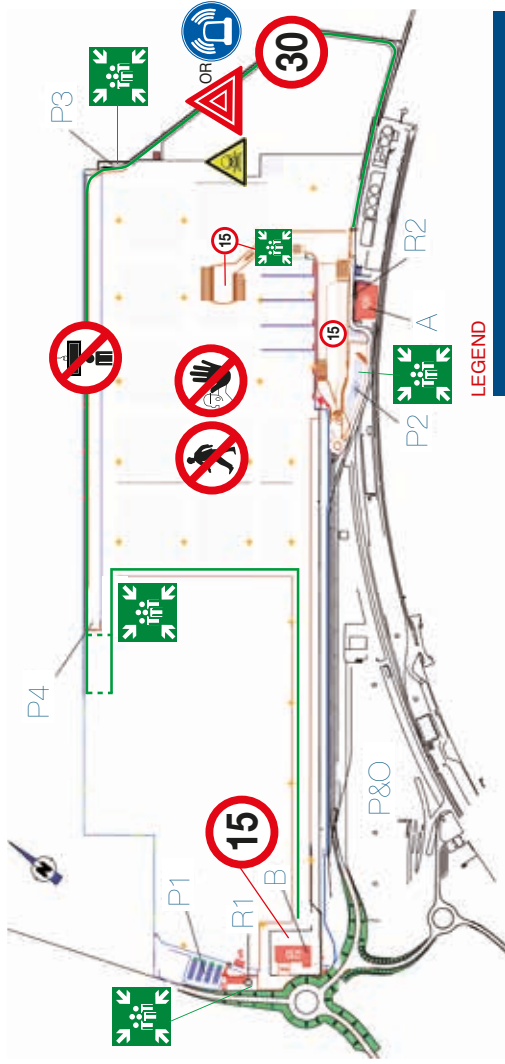

LEGEND

A: ZEESTATION	P3: Lorry Park 3
B: M&R	P4: Lorry Park 4
P1: Lorry Park 1	R1: Smoking area
P2: Lorry Park 2	R2: Smoking area
	F1: Fumigationzone